

Hand Pallet Truck



Model: BF

1KG=2.205LB 1INCH=25.40MM

Model		BF	
Capacity	Q(kg)	2500/3000	2500/3000
Lowered fork height	h ₀ (mm)	85	75
Steering wheel	mm	φ 200	φ 180
Fork wheel single	mm	φ 80x93	φ 74x93
Fork wheel tandem	mm	φ 80x70	φ 74x70
Max. lift height	h ₂ (mm)	200	190
Total height	h ₁ (mm)	1224	1214
Overall length	L ₁ (mm)	1483/1533/1603	1483/1533/1603
Fork length	L ₂ (mm)	1100/1150/1220	1100/1150/1220
Width overall forks	b ₁ (mm)	520/550/685	520/550/685
Ground clearance, centre of wheelbase	m ₁ (mm)	40	30
Aisle width for pallets 1000x1200 crossways	A ₁ (mm)	1683/1733/1803	1683/1733/1803
Aisle width for pallets 800x1200 lengthways	A ₂ (mm)	1783/1783/1803	1783/1783/1803
Turning radius	W ₁ (mm)	1216/1266/1336	1216/1266/1336
Service weight	kg	60-75	60-75

Over
7,200,000
units sold



Innovative design, comprehensive testing and highest quality !

- Most standard and popular model with capacity 2500 - 3000kgs.
- With Copping Supporting NOG & strengthening ribbing under top triangle cover.
- Complete pump design with reliable leak-proof pump eliminating maintenance and extending the service time.
- 210 steering arc, and small turning radius.
- Fork Lowering speed is controllable, operated by hand control and foot pedal.
- Entry / exit roller, more freely travel.
- Equipped with over-load valve, with long service time.
- 3 position hand control - Raise, Lower, Neutral.
- 12 lubrication grease nipples on all movable parts for easy maintenance.
- Adjustable pump cap ensures a long service life.
- Ergonomic large rubber handle with three control lever.
- Option: 1) Nylon wheel, polyurethane wheel, rubber wheel, single fork roller or tandem fork rollers.
2) Fork length: 800mm, 900mm, 1000mm.
3) Foot pedal release.
4) Pump color: black painting, silver painting.



Conforms to EN ISO3691-5
Based on Directive 2006/42/EC

Professional



Option: fully rubber wrapped handle



Adjustable pump cap

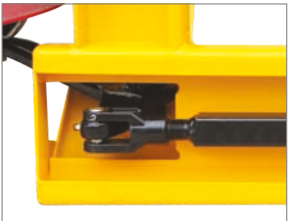

Adjustable straight tappet

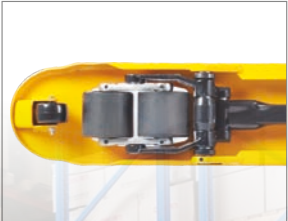

Additional entry and exit roller



Remark: Special size fork width and length can be made according to customer's requirement.



Model: BF-III

1KG=2.205LB 1INCH=25.40MM

Model		BF-III	
Capacity	Q(kg)	2500/3000	2500/3000
Lowered fork height	h ₁₃ (mm)	85	75
Steering wheel	mm	φ 180	φ 180
Fork wheel single	mm	φ 74x93	φ 74x93
Fork wheel double	mm	φ 74x70	φ 74x70
Max. Lifting height	h ₃ (mm)	195	185
Height of tiller in drive position min./max.	h ₁₄ (mm)	1214	1214
Overall length	l ₁ (mm)	1543/1613	1543/1613
Fork length	l (mm)	1150/1220	1150/1220
Width overall forks	b ₃ (mm)	520/550/685	520/550/685
Ground clearance, center of wheelbase	m ₂ (mm)	32	22
Aisle width for pallets 1000x1200 crossways	A ₃ (mm)	1743/1813	1743/1813
Aisle width for pallets 800x1200 lengthways	A ₂ (mm)	1793/1813	1793/1813
Turning radius	W ₂ (mm)	1276/1346	1276/1346
Service weight	kg	56-70	56-70

Remark: Special size fork width and length can be made according to customer's requirement.



Hand pallet truck

- Integrated pump without welding , no any leaking problems.
- Frame force is more reasonable , and the strength is more reliable.
- Handle seat has hole it is more convenient for installation of control chain.
- Forks lowering speed is controllable, with overload valve to avoid overloading .
- Option: 1) steering wheel 200mm (fork wheel 80mm) are available.
2) Nylon wheel, polyurethane wheel, rubber wheel, single fork roller or tandem fork rollers.
3) Fork length: 800mm, 900mm, 1000mm, 1100mm.
4) Foot pedal release.
5) Pump color: black painting.
6) Quick lift (double speed lifting).

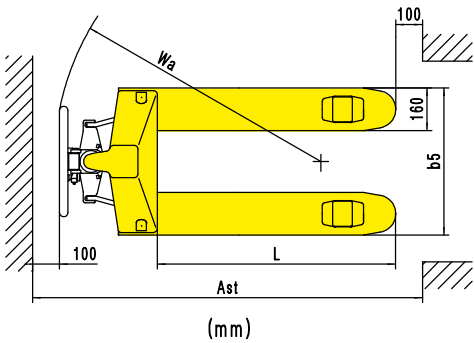
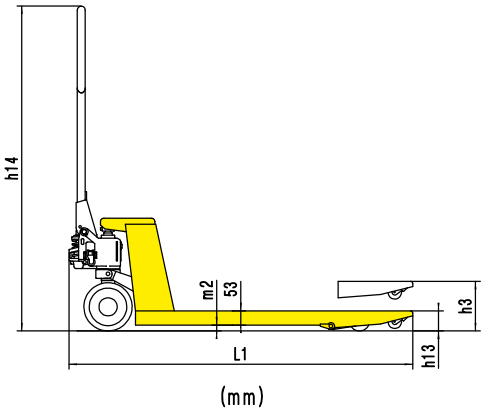

Wheel Option



Handle Option



*Standard: metal handle



*Option: rubber wrapped handle

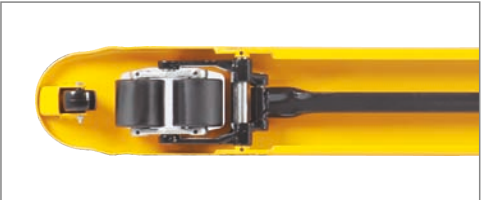

Standard with entry & exist Roller
(option with single or double fork rollers)



Integrated cast pump

Hand Pallet Truck

Model: DB

1KG=2.205LB 1INCH=25.40MM



Model		DB
Capacity	Q(kg)	2000
Lowered fork height	h_{13} (mm)	75
Steering wheel	mm	ϕ 160
Fork wheel single	mm	ϕ 70x80
Fork wheel tandem	mm	ϕ 70x60
Max. lift height	h_2 (mm)	190
Total height	h_{14} (mm)	1176.5
Overall length	l_1 (mm)	1520/1590
Fork length	l (mm)	1150/1220
Width overall forks	b_2 (mm)	520/550/680
Ground clearance, centre of wheelbase	m_2 (mm)	22
Aisle width for pallets 1000x1200 crossways	A_c (mm)	1720/1790
Aisle width for pallets 800x1200 lengthways	A_n (mm)	1770/1790
Turning radius	W_t (mm)	1265/1335
Service weight	kg	53-62

Remark: Special size fork width and length can be made according to customer's requirement.

Standard



Conforms to EN ISO3691-5
Based on Directive 2006/42/EC

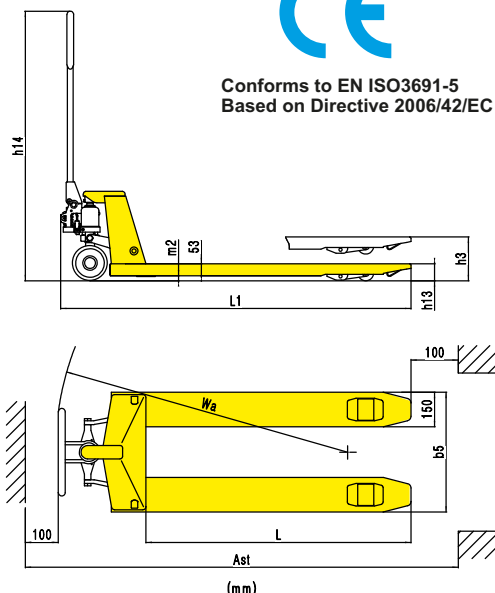

Economic design pallet truck

- Standard epoxy powder coat finish which is resistant to chips and normal corrosion.
- Exceptionally strong but light weight steel construction, service weight is only 55kgs.
- With welded joints and reinforced fork tips for most durability in the toughest applications.
- 3 position hand control - Raise, Lower, Neutral.
- Excellent turning angle of 190 degrees facilities.
- Number of pump strokes 12 times, lift height per stroke 11mm.
- Reliable oil leak-proof hydraulic system.
- Option: 1) Nylon wheel, polyurethane wheel, rubber wheel, single fork roller or tandem fork rollers.
2) Fork length: 800mm, 900mm, 1000mm, 1100mm.

Model: DF-III

1KG=2.205LB 1INCH=25.40MM

Model		DF-III	
Capacity	Q(kg)	2500/3000	2500/3000
Lowered fork height	h_{13} (mm)	85	75
Steering wheel	mm	$\phi 180$	$\phi 160$
Fork wheel single	mm	$\phi 70 \times 80$	$\phi 70 \times 80$
Fork wheel tandem	mm	$\phi 70 \times 60$	$\phi 70 \times 60$
Max. lift height	h_3 (mm)	200	190
Total height	h_{14} (mm)	1186.5	1176.5
Overall length	l_1 (mm)	1520/1590	1520/1590
Fork length	l (mm)	1150/1220	1150/1220
Fork width	e (mm)	150	150
Width overall forks	b_5 (mm)	520/550/680	520/550/680
Ground clearance, centre of wheelbase	m_2 (mm)	32	22
Aisle width for pallets 1000x1200 crossways	A_x (mm)	1720/1790	1720/1790
Aisle width for pallets 800x1200 lengthways	A_x (mm)	1770/1790	1770/1790
Turning radius	W_4 (mm)	1265/1335	1265/1335
Service weight	kg	55-65	55-65

Remark: (1) Capacity 2000kg available.
(2) Special size fork width and length can be made according to customer's requirement.



Standard
(Innovation)



Conforms to EN ISO3691-5
Based on Directive 2006/42/EC

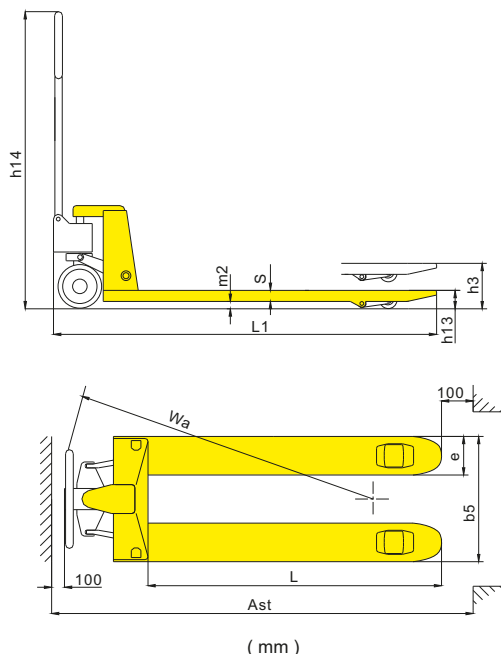

Standard type pallet truck

- Chrome piston and ram for smooth operation and prevents excessive wear on the pump & seal.
- Excellent turning angle of 180 degrees facilities.
- Number of pump strokes-10 times. Lift height per stroke:11mm.
- Option: 1) Nylon wheel, polyurethane wheel, rubber wheel, single fork roller or tandem fork rollers.
2) Fork length: 800mm, 900mm, 1000mm.

Electric Pallet Truck

Electric Stacker

Order Picker

Narrow Aisle Truck

Electric Tow Tractor

Hand Pallet Truck

Manual Stacker

Lift Table

Hand Pallet Truck

Model: **WB** 5000KG

1KG=2.205LB 1INCH=25.40MM

Model		WB	
Capacity	Q(kg)	5000	5000
Lowered fork height	h_{10} (mm)	88	78
Steering wheel	mm	ϕ 200	ϕ 180
Fork wheel single	mm	~	~
Fork wheel tandem	mm	ϕ 85x80	ϕ 75x80
Max. lift height	h_2 (mm)	205	195
Total height	h_{14} (mm)	1253	1243
Overall length	l_1 (mm)	1544/1614	1544/1614
Fork length	l (mm)	1150/1220	1150/1220
Width overall forks	b_2 (mm)	550/685	550/685
Ground clearance, centre of wheelbase	m_2 (mm)	28	18
Aisle width for pallets 1000x1200 crossways	A_w (mm)	1744/1814	1744/1814
Aisle width for pallets 800x1200 lengthways	A_w (mm)	1794/1814	1794/1814
Turning radius	W_t (mm)	1300/1370	1300/1370
Service weight	kg	103-110	103-110

Heavy Duty

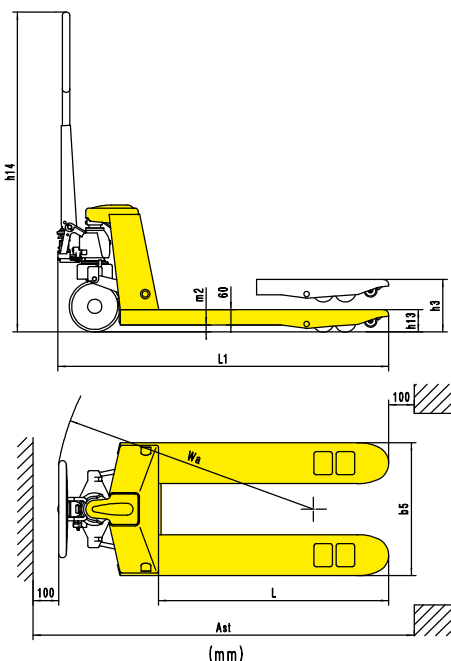

Heavy duty type pallet truck

- High reliability and long service life of 5 years.
- Double lifting speed when loads under 600kg, which turns back to regular speed when above it.
- Impact free lifting ensures safety of cargo loading.
- The lifting system is equipped with overloading protection valve to ensure the safe operation.
- The utilized structural design guarantees the convenience of assembling and disassembling.
- Light-weight fork frame, made from high rigidity steel plate.
- Compact appearance, complete rocker arm, ensure the whole truck evenly pressed.
- There is a finger hole in the connection of handle and pump, easy to assemble.

Model: BFA

Advantages:

- 90% less full loading pull strength than normal truck.
- Reverse brake function avoid the reverse sliding on the slope.

Operating Introductions:

- Lift the fork and let the handle at the neutral position.
- Pull the left power-assisted lever at the bottom position, flapping the handle, very easy to start the truck.

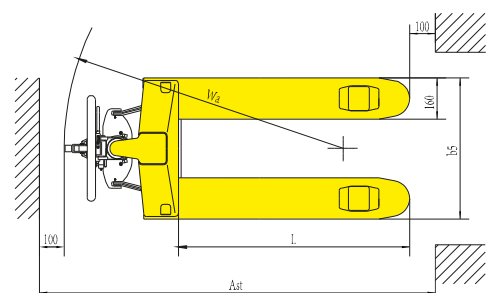
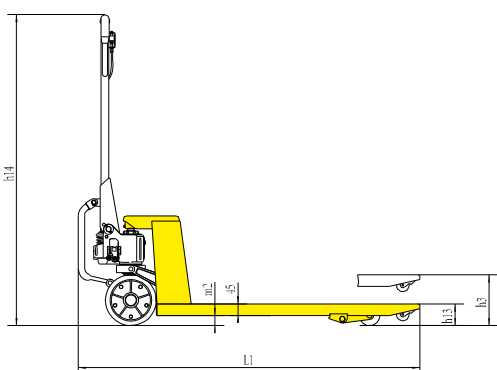

1KG=2.205LB 1INCH=25.40MM

Model	BFA		
Capacity	kg	2500	2500
Lowered fork height	$h_{1,2}$ (mm)	85	75
Steering wheel	mm	$\Phi 200$	$\Phi 180$
Fork wheel single	mm	$\Phi 80 \times 93$	$\Phi 74 \times 93$
Fork wheel double	mm	$\Phi 80 \times 70$	$\Phi 74 \times 70$
Max.lift height	mm	200	190
Height of tiller	$h_{1,2}$ (mm)	1224	1214
Overall length	l_1 (mm)	1483/1533/1603	1483/1533/1603
Fork length	l (mm)	1100/1150/1220	1100/1150/1220
Width overall forks	b_5 (mm)	520/550/685	520/550/685
Ground clearance, center of wheelbase	m_2 (mm)	40	30
Aisle width for pallets 1000x1200 crossways	$A_{1,2}$ (mm)	1683/1733/1803	1683/1733/1803
Aisle width for pallets 800x1200 lengthways	$A_{1,2}$ (mm)	1783/1783/1803	1783/1783/1803
Turning radius	W_4 (mm)	1216/1266/1336	1216/1266/1336
Service weight	kg	65-77	65-77

Multi-function Hand Pallet Truck

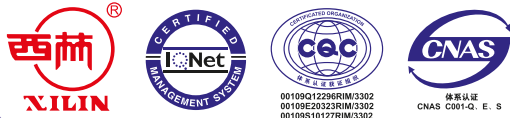

Model: **BF3500**
Heavy Duty Pallet Truck

1KG=2.205LB 1INCH=25.40MM		
Model	BF3500	
Capacity	(kg)	3500
Lowered fork height	(mm)	85/75
Total lift height	(mm)	200/190
H. of handleless	(mm)	443/433
Fork length	(mm)	1150/1220
Width overall forks	(mm)	550/685
Steering wheel	(mm)	φ 200/ φ 180
Fork wheel	(mm)	φ 80/ φ 74
Truck weight	(kg)	100



Model: **BFR**
Pallet Truck With Backrest

1KG=2.205LB 1INCH=25.40MM		
Model	BFR	
Capacity	(kg)	2500
Lowered fork height	(mm)	85/75
Total lift height	(mm)	200/190
H. of handleless	(mm)	431.5/421.5
Fork length	(mm)	1150/1220
Width overall forks	(mm)	520/550/685
Steering wheel	(mm)	φ 200/ φ 180
Fork wheel	(mm)	φ 80/ φ 74
Truck weight	(kg)	95/105



Model: **BFW BFWL**
Extra Wide Pallet Truck

1KG=2.205LB 1INCH=25.40MM			
Model	BFW		BFWL
Capacity	(kg)	1500	1500
Lowered fork height	(mm)	85/75	52
Total lift height	(mm)	200/190	140
H. of handleless	(mm)	431.5/421.5	396
Fork length	(mm)	1150/1220	1150/1220
Width overall forks	(mm)	830	830
Steering wheel	(mm)	φ 200/ φ 180	φ 150
Fork wheel	(mm)	φ 80/ φ 74	φ 50
Truck weight	(kg)	100	100



Model: **BFZ**
Super Narrow Pallet Truck

1KG=2.205LB 1INCH=25.40MM		
Model	BFZ	
Capacity	(kg)	2000
Lowered fork height	(mm)	75
Total lift height	(mm)	190
H. of handleless	(mm)	401.5
Fork length	(mm)	800
Width overall forks	(mm)	406
Steering wheel	(mm)	φ 160
Fork wheel	(mm)	φ 70
Truck weight	(kg)	65



CE Conforms to EN ISO3691-5
Based on Directive 2006/42/EC

Model: **WF**
MINI Pallet Truck

Only 35kg!

1KG=2.205LB 1INCH=25.40MM		
Model	WF	
Capacity	Q(kg)	500
Lowered fork height	h ₁ (mm)	60
Steering wheel	mm	φ 127
Fork wheel	mm	φ 58
Max. lift height	h ₂ (mm)	150
Total height	h ₃ (mm)	1127
Overall length	l ₁ (mm)	1126
Fork dimensions	s/e/l	40/100/800
Width overall forks	b ₂ (mm)	380
Service weight	kg	35



Model: **BFJ**
Reel Carrier Pallet Truck

1KG=2.205LB 1INCH=25.40MM		
Model	BFJ	
Capacity	(kg)	1000
Diameter of bale	(mm)	φ 700~φ 1200
Height of handleless	(mm)	431.5
Fork length	(mm)	1150
Max width overall forks	(mm)	965
Steering wheel	(mm)	φ 200
Fork wheel	(mm)	φ 80
Weight	(kg)	135



Model: **HW**
Rough Terrain Truck
• Special for building site

1KG=2.205LB 1INCH=25.40MM		
Model	HW	
Capacity	(kg)	1500
Lowered fork height	(mm)	70
Total lift height	(mm)	240
Height of handleless	(mm)	734
Total height	(mm)	1298
Total width	(mm)	1605
Fork length	(mm)	800
Max width overall forks	(mm)	740
Least width overall forks	(mm)	226
Steering wheel	(mm)	φ 250x60
Fork wheel	(mm)	φ 380x114
Weight	(kg)	192



Extra Long Pallet Truck
• Different fork size can be made according to customers' requirement.



Model: **BFC6-7**
BFC6-8
(Scale pallet truck with printer)



Premium



Conforms to EN ISO3691-5
Based on Directive 2006/42/EC

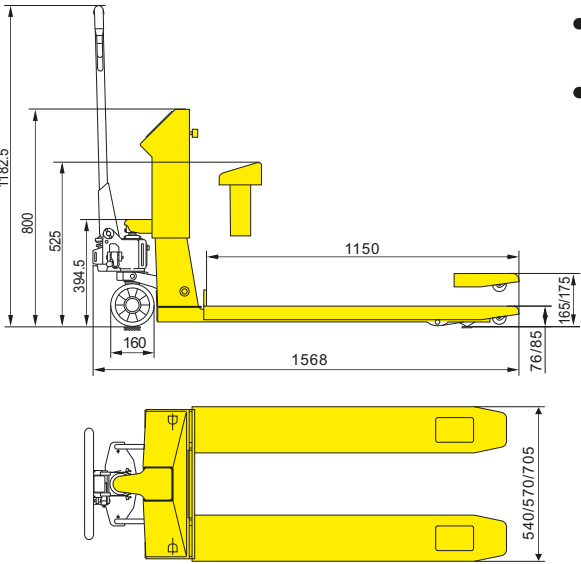

- Mobile pallet truck with scale combined two major functions for pallet truck/scale, allows you to weigh cargo whatever, wherever, whenever you want.
- Power supply with rechargeable battery or with 86~264V AC input .
- Keypad and automatic tare functions.
- 1.2inches, super-large and bright LED display in solid state to be strike-free.
- Available in pounds or kilograms.
- A/D velocity: 27/s, a faster speed of weighing, more correct.
- Various functions: with extended functions as weight-checking ,counting, etc., to satisfy different needs of customers.
- Conforms to EU's ROHS standard.

1KG=2.205LB 1INCH=25.40MM

Model	BFC6/BFC6-II		BFC6-7/BFC6-8
Capacity	(kg)	2000	2000
Lowered fork height	(mm)	76/85	76/85
Total lift height	(mm)	165/175	165/175
Fork length	(mm)	1150	1150
Width overall forks	(mm)	540/570/705	540/570/705
Steering wheel	(mm)	φ 160	φ 160
Fork wheel	(mm)	φ 70	φ 70
Power	Dry cell / Ni MH rechargeable battery		Lead-acid battery
Max deviation (weight)	(kg)	0.5	0.5
Max. deviation (rate)	(%)	±0.1%	±0.1%
Service weight	(kg)	133-142	133-142



Hot Sale



Model: **BFC6-7E**
BFC6-8E
(Scale pallet truck with printer)

- The instrument operation interface is concise and easy to operate.
- The display screen is 6-digit LCD display, and the screen is inclined forward, which is convenient for the operator to read the value.
- The maximum error value of the instrument is 0.1%, and the weighing accuracy is 0.5kg.
- Five functional buttons, easy and simple to operate.
- It can switch the weighing unit (kg / lb) with one key, which is convenient for use in different markets requirements.
- The instrument power supply adopts 4.8V/4AH lithium battery, which can be used continuously for more than 60 hours, stand-by for up to 300 hours, and charging only takes 5 hours.
- The instrument screen is equipped with backlight, which will automatically light up when the weight changes, which is convenient for the operator to check; after the weight is stable, the backlight will automatically turn off for saving energy.
- The back of the instrument is totally enclosed, and the harness connection adopts aviation connector / RS232 connector, which improves the overall protection performance of the instrument.
- The whole instrument is protected by iron plate, which prevents the instrument from bumping and damage during operation.
- Optional thermal printer, with no need to change the color band.

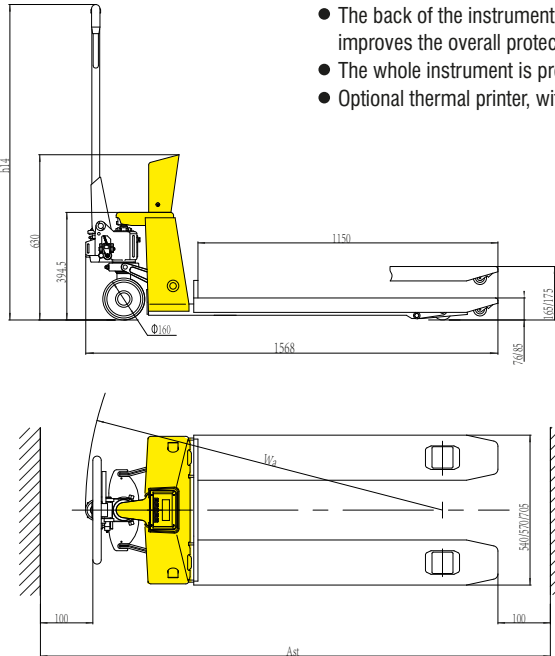

1KG=2.205LB 1INCH=25.40MM

Model	BFC6-7E/BFC6-8E	
Capacity	(kg)	2000
Lowered fork height	(mm)	76/85
Total lift height	(mm)	165/175
Fork length	(mm)	1150
Width fork overall	(mm)	540/570/705
Steering wheel	(mm)	φ 160
Fork wheel	(mm)	φ 70
Power	4.8V/4Ah li-ion battery	
Max. deviation (weight)	(kg)	0.5
Max. deviation (rate)	(%)	±0.1%
Turning radius	(mm)	1368
Service weight	(kg)	115-130

Scale Pallet Truck

High Lift Truck

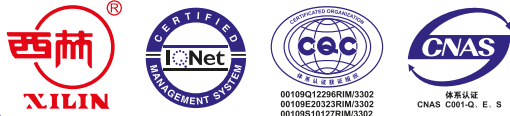

Model:
BFC6-7(S)
Stainless Steel Scale Truck

1KG=2.205LB 1INCH=25.40MM

Model	BFC6-7(S)	
Capacity	(kg)	2000
Lowered fork height	(mm)	76/85
Total lift height	(mm)	165/175
Fork length	(mm)	1150
Width overall forks	(mm)	540/570/705
Steering wheel	(mm)	φ 160
Fork wheel	(mm)	φ 70
Power	Lead-acid battery	
Max deviation (weight)	(kg)	0.5
Max. deviation (rate)	(%)	±0.1%
Service weight	(kg)	130

- The display appearance with simple design, concise and clear.
- Super large 5- digit LCD display screen .
- The scale accuracy, Maximum error 0.05%, weighing accuracy 0.5kg, max to 0.2kg.
- 4 function button, very easy and convenience to operation.
- The front of display with U protective shield, prevent instrument damaged during operation.

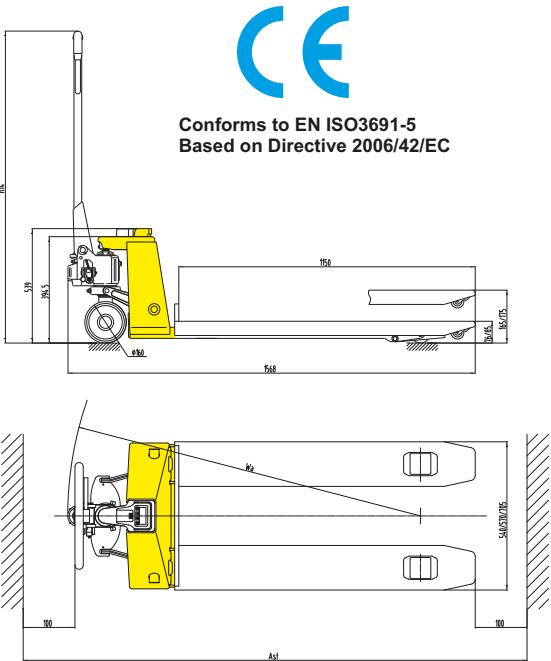

CE
Conforms to EN ISO3691-5
Based on Directive 2006/42/EC

Model:
BFC6-7M



Standard

1KG=2.205LB 1INCH=25.40MM

Model	BFC6-7M	
Capacity	kg	2000
Lowest fork height	mm	76/85
Max Lifting Height	mm	165/175
Fork length	mm	1150
Width overall forks	mm	540/570/705
Steering wheel	mm	Φ160
Fork wheel	mm	Φ70
Battery	dry battery	
Max deviation (weight)	kg	0.5
Max deviation (rate)	%	±0.05%
Turning Radius	mm	1368
Service weight	kg	118-130

Model: **JF**



Conforms to EN ISO3691-5
Based on Directive 2006/42/EC

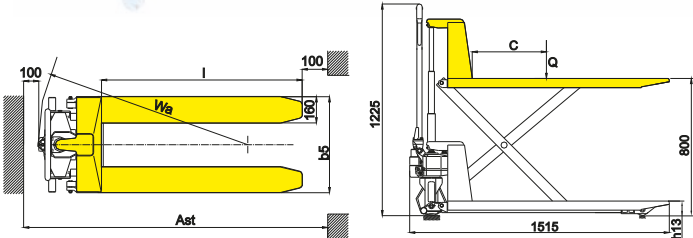

1KG=2.205LB 1INCH=25.40MM

Model	JF	
Capacity	Q(kg)	1000
Lowered fork height	h ₁ (mm)	85
Steering wheel	mm	Φ 180X50
Fork wheel	mm	Φ 74X50
Fork length	l (mm)	1150
Width overall forks	b ₁ (mm)	520/550/685
Aisle width for pallets 1000x1200 crossways	A ₁ (mm)	1715
Aisle width for pallets 800x1200 lengthways	A ₂ (mm)	1765
Turning radius	W ₁ (mm)	1360
Service weight	kg	104-115

Model: **JFD8**



Conforms to EN ISO3691-1
EN1175
EN16307-1
Based on Directive 2006/42/EC

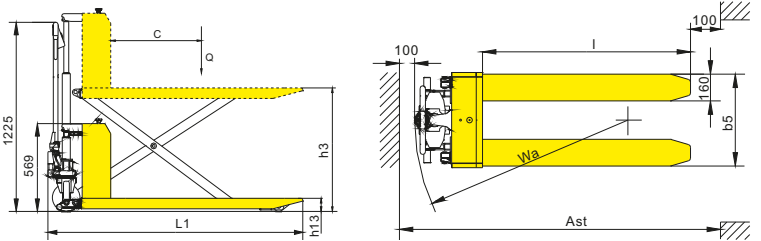

1KG=2.205LB 1INCH=25.40MM

Model	JFD8	
Capacity	Q(kg)	1000
Lowered fork height	h ₁ (mm)	85
Steering wheel	mm	Φ 180x50
Fork wheel	mm	Φ 74x50
Max. lift height	h ₂ (mm)	800
Overall length	L ₁ (mm)	1652
Fork length	l (mm)	1245
Width overall forks	b ₁ (mm)	550/685
Aisle width for pallets 1000x1200 crossways	A ₁ (mm)	1852
Aisle width for pallets 800x1200 lengthways	A ₂ (mm)	1852
Turning radius	W ₁ (mm)	1480
Lift motor rating at S3 15%	kW	0.7
Battery voltage,nominal capacity K10	V/Ah	12/100
Battery weight	kg	31
Service weight (with battery)	kg	181

Electric Pallet Truck

Electric Stacker

Order Picker

Narrow Aisle Truck

Electric Tow Tractor

Hand Pallet Truck

Manual Stacker

Lift Table